

# POLYTOP

Exporter from china

## PTK72-A SERIES DIRECT MOUNTING 4-JAW INDEPENDENT CHUCKS:



PTK72-A series four-jaw independent chucks are of direct mounting type and can be directly joined to the spindle nose of the machine tool featuring reliable accuracy, nice rigidity, short overhung and rapid changeover etc.

This series can be joined to the machine tool spindle nose in three ways A<sub>2</sub> C and D forms. The parameters meet GB5900.1-GB5900.3(ISO-702) standard.

### 1. Form A<sub>2</sub>: Mount with perforating screw

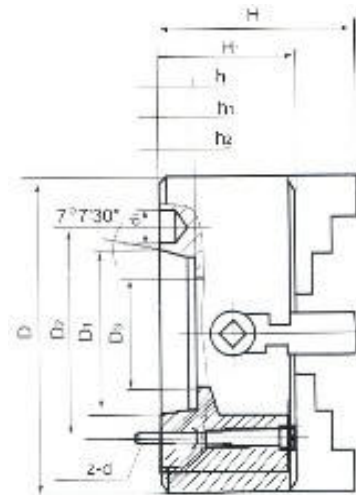

Size D	No of spindle head	D <sub>1</sub>	D <sub>2</sub>	D <sub>3</sub>	H	H <sub>1</sub>	h	h <sub>1</sub>	h <sub>2</sub>	d <sub>1</sub>	z-d	
200	4	63.513	82.6	56	110	75	13	10	6.5	14.7	4-M10	
250					115.5	80						
200	5	82.563	104.8	56	110	75	15	12	6.5	16.3		
250					115.5	80						
320					134	90						
250	6	106.375	133.4	75	115.5	80	16	13	6.5	19.5		4-M12
320					134	90						
350					141	90						
400					143	95						
250	8	139.719	171.4	75	115.5	80	18	14	8.0	24.2		4-M16
320					95	134					90	
400					125	143					95	

450					147	100					
500				130	161	106					
630					180	115					
400				160	143	95					
500					161	106					4-M20
630	11	196.869	235.0		180	115	20	16	10.0	29.4	
800				180	210	135					8-M20
1000					241	150					
1250					256	165					
630				241	180	115					
800				180	210	135			10.0		8-M22
1000	15	285.775	330.2		241	150	21	17		35.7	
1000T				280							8-M20
1250T					256	165			20.0		8-M22
1250	20	412.775	463.6	280	256	165	23	19	10.0	42.1	8-M24

**2. Form C : Mount with catch plate and locknuts**

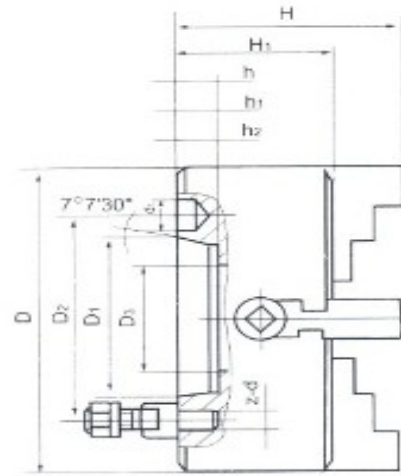

Size D	No of spindle head	D <sub>1</sub>	D <sub>2</sub>	D <sub>3</sub>	H	H <sub>1</sub>	h	h <sub>1</sub>	h <sub>2</sub>	d <sub>1</sub>	z-d
160	3	53.975	75.0	45	96.5	65			--	--	
160							13	10			3-M10
200	4	63.513	85.0	56	110	75			6.5	14.7	
250					115.5	80					
200					110	75					
250	5	82.563	104.8	56	115.5	80	15	12	6.5	16.3	4-M10
300					128.5	85					
320					134	90					
250					115.5	80					
300					128.5	85					
320	6	106.375	133.4	75	134	90	16	13	6.5	19.5	4-M12
350					141	90					
400					143	95					
500					161	106					
250				95	115.5	80					
320	8	139.719	171.4		134	90	18	14	8.0	24.2	4-M16

400				125	143	95						
500					161	106						
500	11	196.869	235	160	161	106	20	16	10.0	29.4	6-M20	
1250	15	285.775	330.2	280	256	165	21	17	10.0	35.7	6-M24	

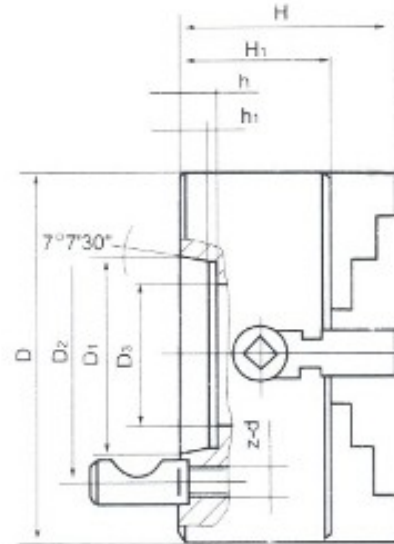

### 3. Form D : Mount with connecting bar and camlocks

Size D	No of spindle head	D <sub>1</sub>	D <sub>2</sub>	D <sub>3</sub>	H	H <sub>1</sub>	h	h <sub>1</sub>	z-d
160	3	53.975	70.6	45	96.5	65			
160	4	63.513	82.6	56	110	75	13	10	3-M10 <sub>j</sub> Á1
200									
250									
200	5	82.563	104.8	56	110	75	15	12	6-M12 <sub>j</sub> Á1
250					115.5	80			
300					128.5	85			
320					134	90			
250	6	106.375	133.4	75	115.5	80	16	13	6-M16 <sub>j</sub> Á1.5
300					128.5	85			
320					134	90			
350					141	90			
400					143	95			
320	8	139.719	171.4	95	134	90	18	14	6-M20 <sub>j</sub> Á1.5
350				141	90				
400				143	95				
450				147	100				
500	11	196.869	235.0	160	161	106	20	16	6-M20 <sub>j</sub> Á1.5
400					143	95			6-M24 <sub>j</sub> Á1.5
500					161	106			
630	15	285.775	330.2	180	180	115	21	17	ii
ii	ii	ii	ii	ii	ii	ii	ii	ii	ii